

Pointe Plaza

Mack Avenue & Moross Road ~ Grosse Pointe Woods, Michigan 48236



Pointe Plaza is located in Grosse Pointe Woods which is just outside of the Detroit city limits. This densely populated residential area is one of the most vibrant communities in Wayne County. Traffic volumes are exceptional with easy access to I-94 and other major freeways and thoroughfares.

Pointe Plaza is next to St. Johns Hospital and in close proximity to local community colleges, universities and other major medical centers.

Join Rite Aid,, Barnes & Noble, Dress Barn, and many others

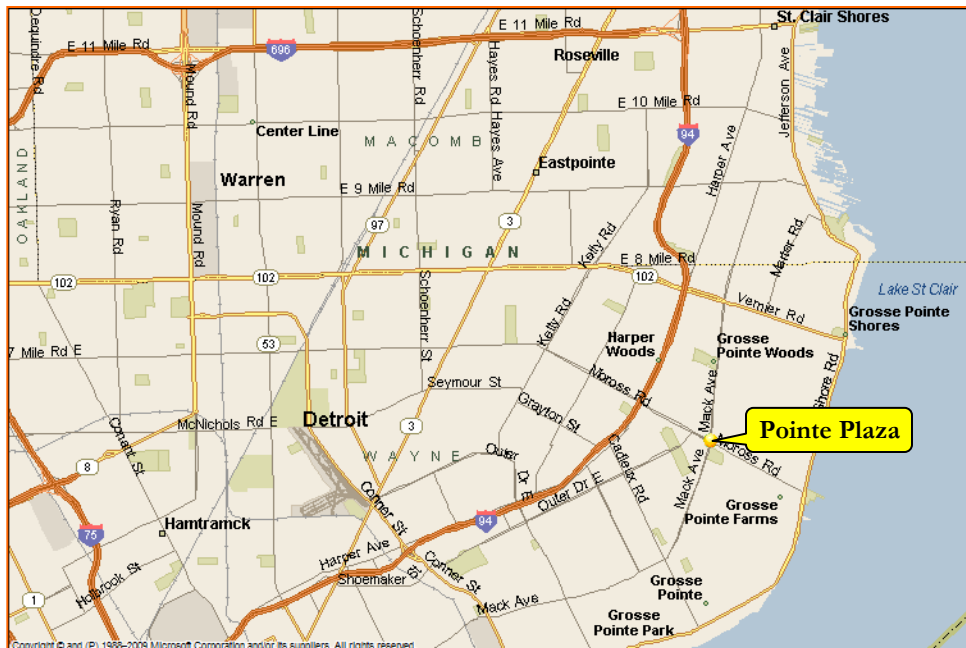

Property Features:	
Built	1990
Total Center GLA	70, 362 SF
Major Retailers	
Rite Aid	13,366 SF
Barnes & Noble	12,482 SF
Dress Barn	7,651 SF
Demographic Facts:	
2010 Population	
3 Mile	127,809
5 Mile	278,962
2010 Median HH Income	
3 Mile	\$56,497
5 Mile	\$45,632
Traffic Counts:	
Moross Rd	56,534 ADT
Mack Avenue	28,689 ADT



Pointe Plaza

Mack Avenue & Moross Road ~ Grosse Pointe Woods, Michigan 48236

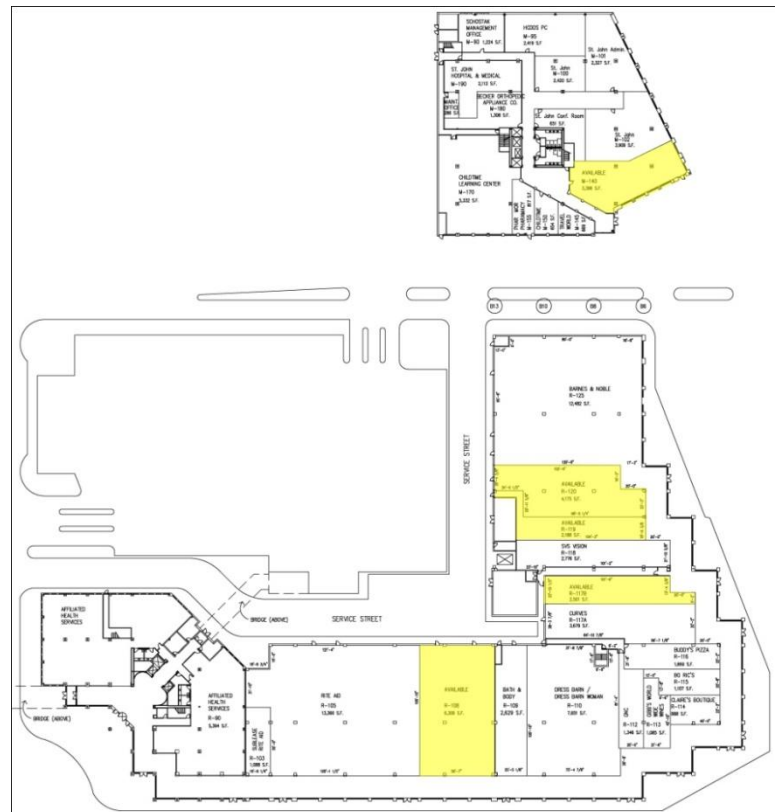

TENANT ROSTER

- R-103 Sublease to Rite Aid - 1,088 SF
- R-105 Rite Aid - 13,566 SF
- R-108 Available - 6,306 SF
- R-109 Bath & Body - 2,629 SF
- R-110 Dress Barn - 7,651 SF
- R-112 GNC - 1,346 SF
- R-113 Gibbs World Wide Win - 1,085 SF
- R-114 Claire's Boutique - 888 SF
- R-115 Bo Ric's - 1,107 SF
- R-116 Buddy's Pizza - 1,669 SF
- R-117A Curves - 3,679 SF
- R-117B Available - 2,501 SF
- R-118 SVS Vision - 2,776 SF
- R-119 Available - 2,188 SF
- R-120 Available - 4,175 SF
- R-125 Barnes & Noble - 12,482 SF

For Additional Information Please Contact:

Justine Ross
Senior Leasing Representative
Office 248.357.6220 Cell 734.626.2626
Ross@schostak.com