

Retail For Lease

Bloomfield Plaza

Maple Rd & Telegraph Rd ~ Bloomfield Hills, MI



Up to 18,500 SF Available

◆ Community center located in one of the most affluent residential communities in Oakland County, featuring unique, specialty retail and convenient shopping.

Demographic Facts:

	<u>3 Mile</u>	<u>5 Mile</u>
2009 Population	42,935	166,691
2009 Est. Median HH Income	\$140,644	\$97,915

Schostak
BROTHERS & COMPANY

www.schostak.com

17800 Laurel Park Drive, Suite 200C

Livonia, Michigan 48152

(248) 262-1000

For More Information Contact:

Lars Anderson

(248) 357-6242

Retail For Lease

Bloomfield Plaza

Maple Rd & Telegraph Rd ~ Bloomfield Hills, MI



LEGEND

LAND AREA	16.23 ACRES
BUILDING AREAS	
BIRMINGHAM BLOOMFIELD	2,815 S.F.
SILVER CINEMA	14,500 S.F.
BLOOMFIELD PLAZA SHOPS (NOT INCLUDING MALL)	136,714 S.F.
ARCADIA'S	13,564 S.F.
TOTAL	167,993 S.F.
PARKING PROVIDED	991 SPACES
	5,917,000 S.F.



BLOOMFIELD PLAZA
 BLOOMFIELD TOWNSHIP, MICHIGAN

LEASE / SITE PLAN

SCALE: 0 25 50 100

MANAGER/DEVELOPER:

1010' S 0°90' W

50' S 0°90' W

700' S 89°32'0" W

700' N 89°32'0" E

700' N 89°32'0" E

50' N 0°90' E

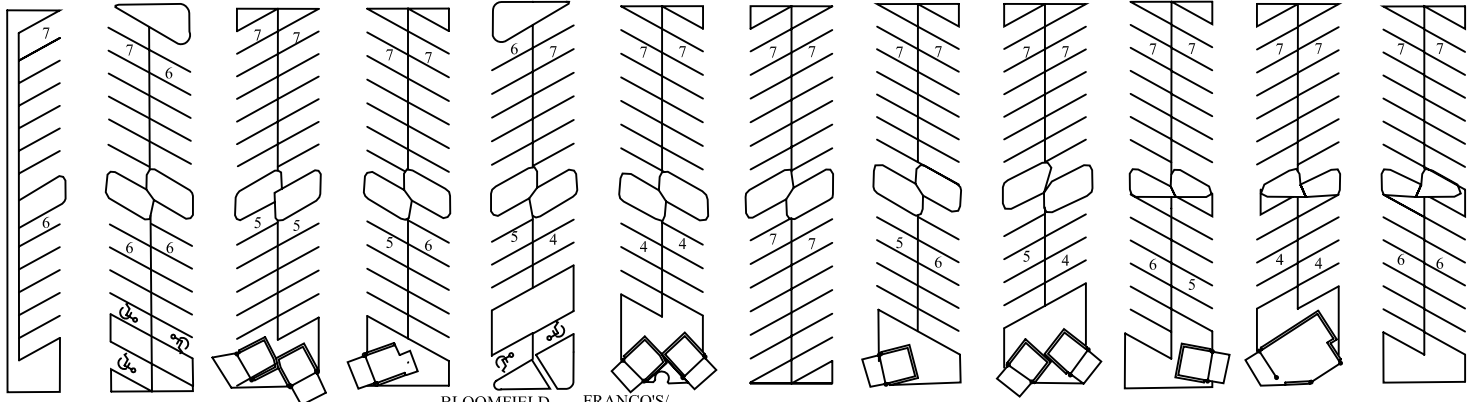

LEGEND

LAND AREA	16.23 ACRES
BUILDING AREAS	
BIRMINGHAM BLOOMFIELD	2,815 S.F.
SILVER CINEMA	14,500 S.F.
BLOOMFIELD PLAZA SHOPS (NOT INCLUDING MALL)	136,714 S.F.
ANDIAMO'S	13,564 S.F.
TOTAL	167,593 S.F.
PARKING PROVIDED	991 SPACES 5.91/1000 S.F.

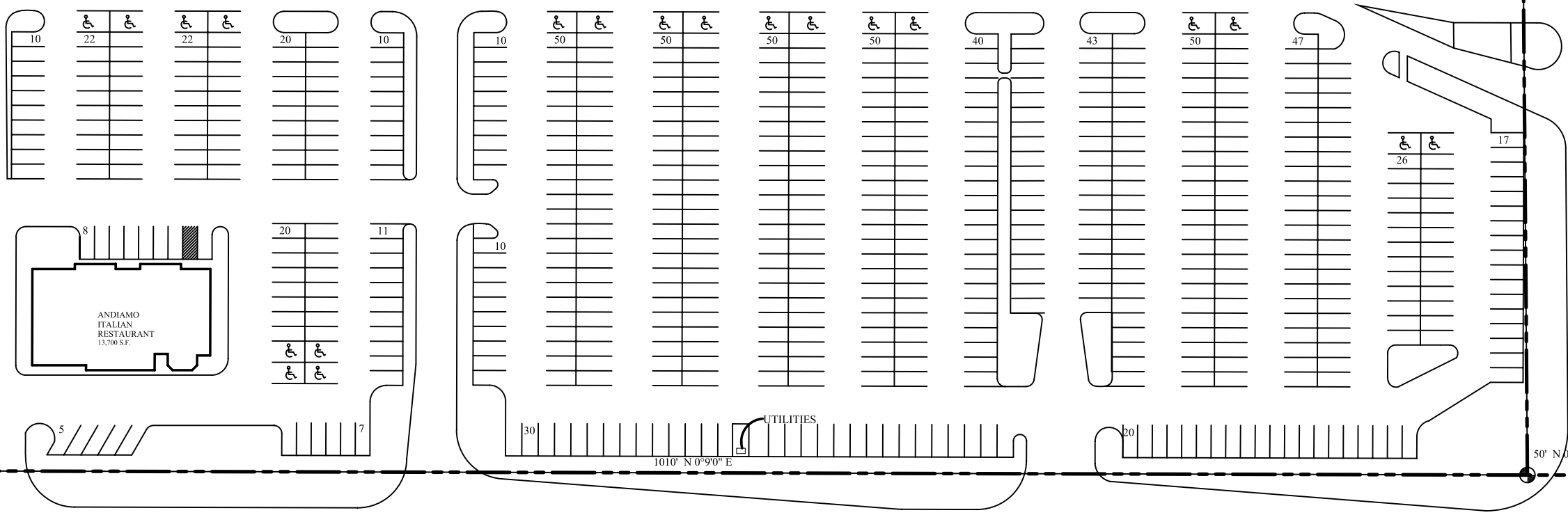
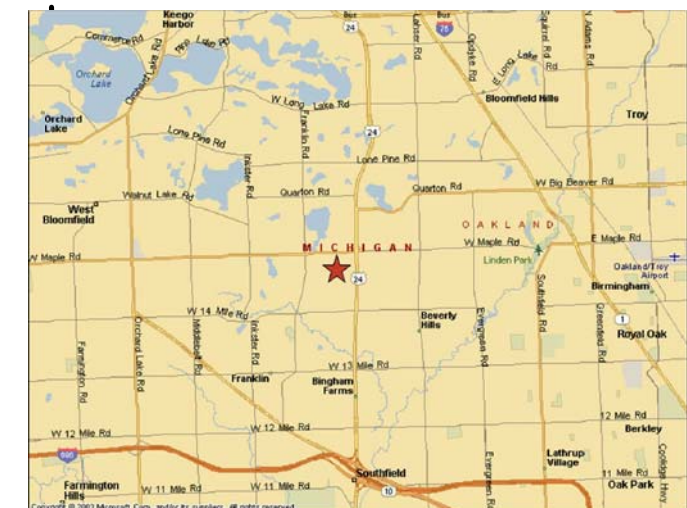
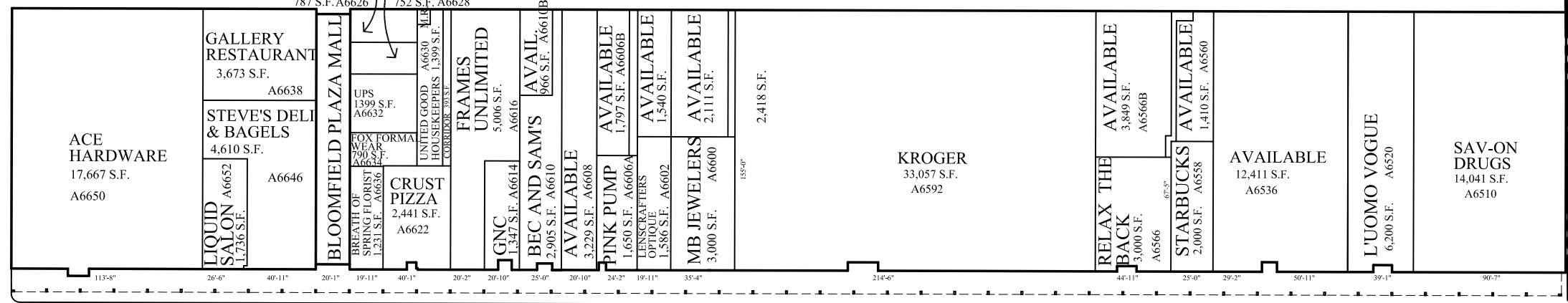

BLOOMFIELD PLAZA
BLOOMFIELD TOWNSHIP, MICHIGAN

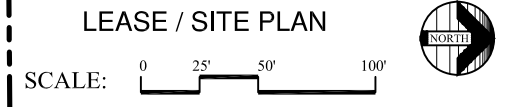

MANAGER/DEVELOPER:
Schostak
BROTHERS & COMPANY
17800 Laurel Park Drive North Livonia, MI 48152
(248) 262-1000

JANUARY 21, 2010

TELEGRAPH RD.

VICINITY MAP

Bloomfield Plaza
Bloomfield Hills, MI



Billingsgate Ct

Maple Rd (Average Daily Traffic – 30,583)

Telegraph Rd (Average Daily Traffic – 79,600)

Bloomfield Plaza

SAV-ON DRUGS
Your Neighborhood Drug Store and More.



ACE

LANDMARK
THEATRES

GAP

Country Club Dr

Cathedral Dr



Date: 01/12/10

Current Geography Selection: (3 Selected) 1,3,5 mile radii: W MAPLE RD & TELEGRAPH RD, BLOOMFIELD, MI 48301

Lat: 42.544760 **Long:** -83.285200

City: Bloomfield Township **Pop:** 40,454

County: Oakland County **Pop:** 1,186,334

Zip: 48301 **Pop:** 14,026

Demographic Snapshot Comparison Report

	1 Miles:	3 Miles:	5 Miles:
Population: 2009			
Total Population	4,841	42,925	166,691
Male Population	49.3%	49.2%	48.0%
Female Population	50.7%	50.8%	52.0%
Median Age	49.7	48.4	46.5
Population Density (per sq. mi.)	1,541.0	1,518.2	2,122.4
Employees	2,552	28,876	161,706
Establishments	242	3,163	14,848
Income: 2009			
Median HH Income	\$122,556	\$140,644	\$97,915
Per Capita Income	\$67,740	\$76,201	\$55,061
Average HH Income	\$159,264	\$192,973	\$129,599
Households: 2009			
Total Households	2,126	16,785	70,175
Average Household Size	2.27	2.55	2.34
Household Growth 1990 - 2000	5.3%	2.4%	5.3%
Housing: 2009			
Owner Occupied Housing Units	74.4%	81.0%	69.0%
Renter Occupied Housing Units	15.8%	9.7%	21.3%
Vacant Housing Units	9.8%	9.3%	9.7%
Race: 2009			
White	86.1%	84.9%	74.4%
Black	5.1%	7.0%	16.6%
American Indian, Eskimo, Aleut	0.1%	0.2%	0.2%
Asian	7.0%	6.1%	6.3%
Hawaiian or Pacific Islander	0.1%	0.0%	0.1%

Other	0.5%	0.4%	0.5%
Multirace	1.2%	1.5%	2.1%
Ethnicity: 2009			
Hispanic	1.9%	1.6%	1.9%
Non-Hispanic	98.1%	98.4%	98.2%

Current year data is for the year **2009**, 5 year projected data is for the year **2014**. More About Our Data.
Demographic data © 2009 by Experian/Applied Geographic Solutions.

© 2009. DemographicsNow is brought to you by SRC, LLC.

SRC, DemographicsNow.com and the SRC and DemographicsNow.com logos are trademarks of SRC, LLC. All rights reserved.

[Privacy Statement](#) | [License Agreement](#)