

Retail For Lease

Lakewood Center

I-94 & Rawsonville Road ~ Van Buren Township, MI



Up To 41,600 Square Feet Available

- ◆ Serving the Greater Van Buren Township Area.
- ◆ Great Family Shopping Destination including Kmart, Dunham's, Fashion Bug, Dollar Tree, Dollar General and more.

Demographic Facts:

	<u>3 Mile</u>	<u>5 Mile</u>
2009 Population	40,646	116,188
2009 Est. Median HH Income	\$59,660	\$57,711



www.schostak.com

17800 Laurel Park Drive, Suite 200C

Livonia, Michigan 48152

(248) 262-1000

For More Information Contact:

Rick Reardon

(248) 357-6142

Retail For Lease

Lakewood Center

I-94 & Rawsonville Road ~ Van Buren Township, MI

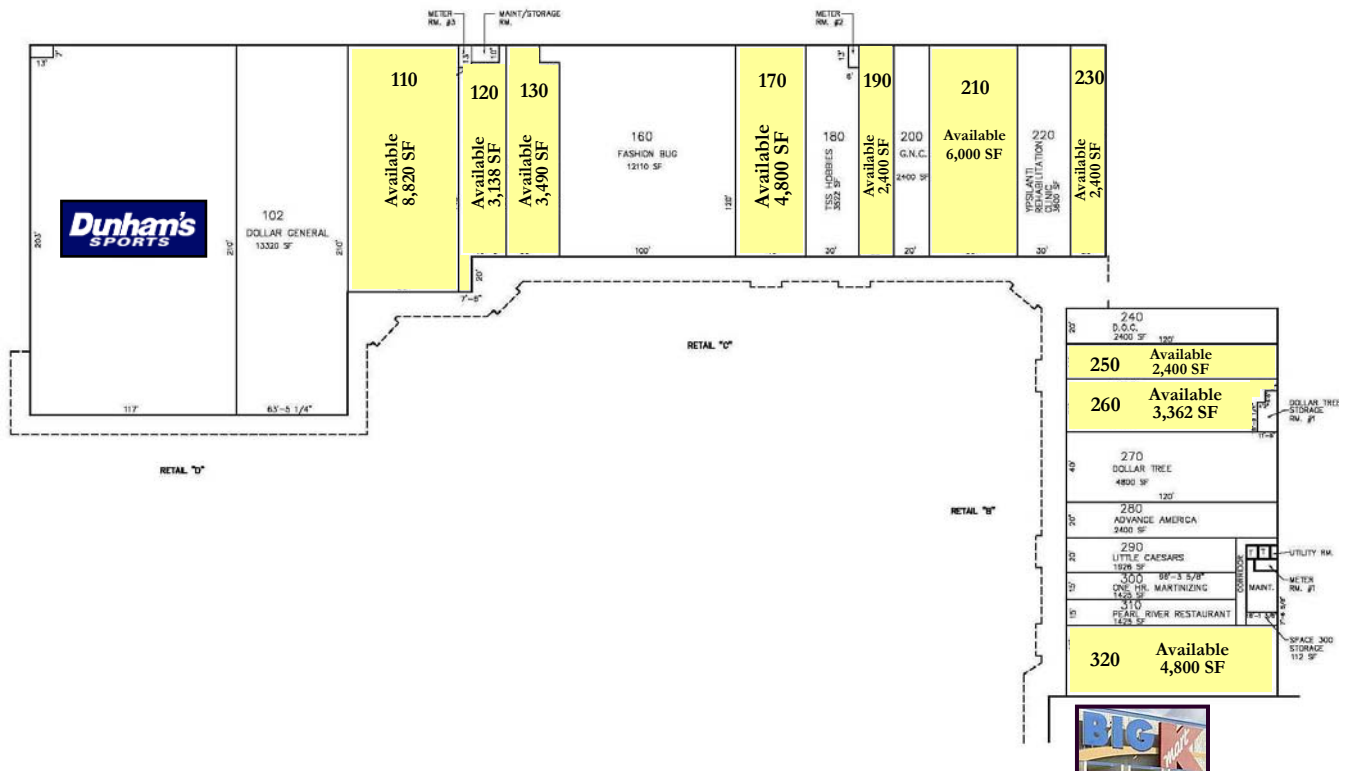

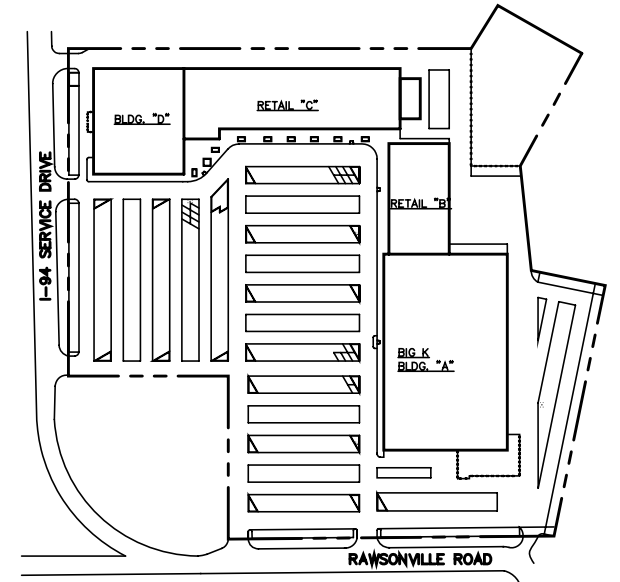
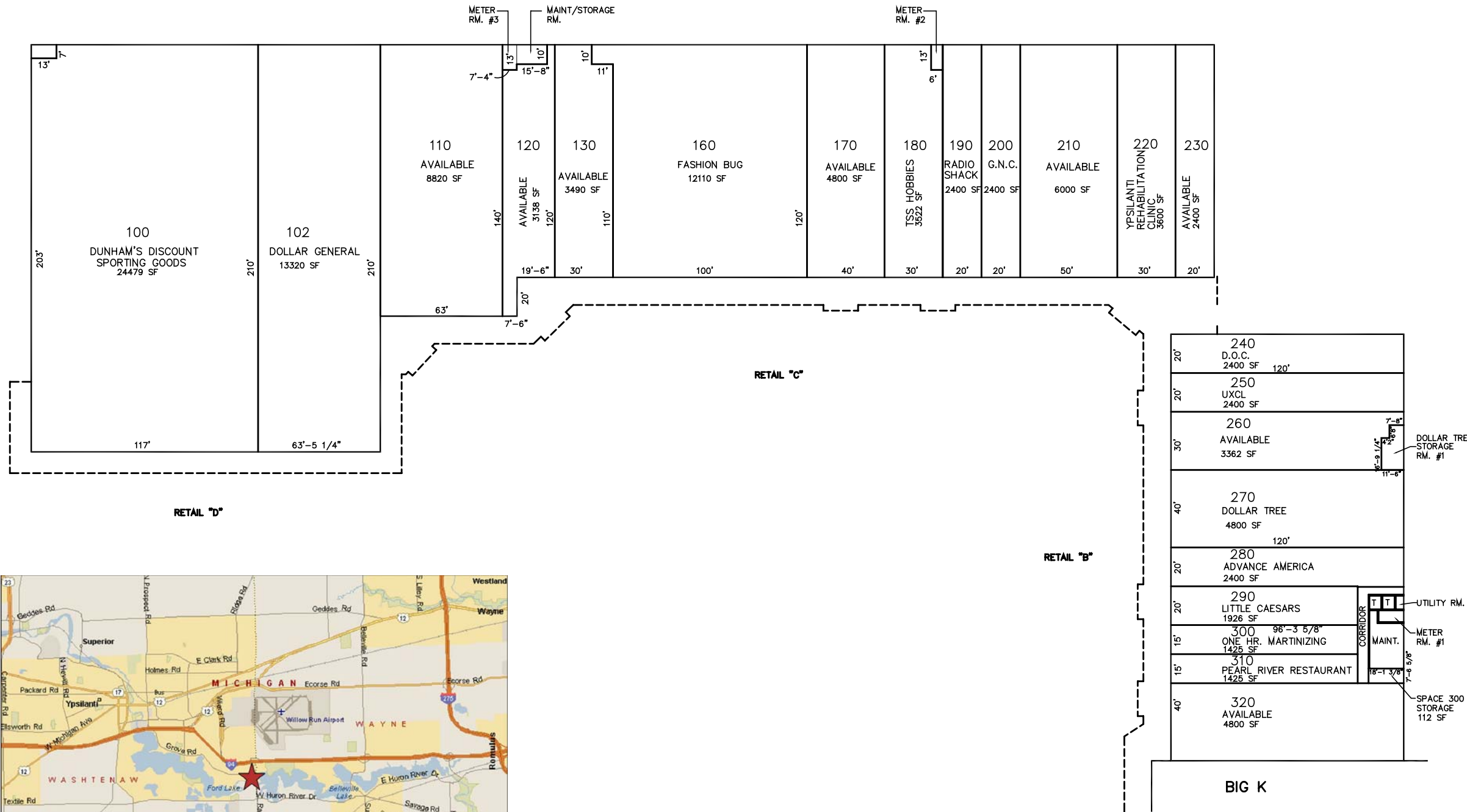

SITE PLAN
NO SCALE

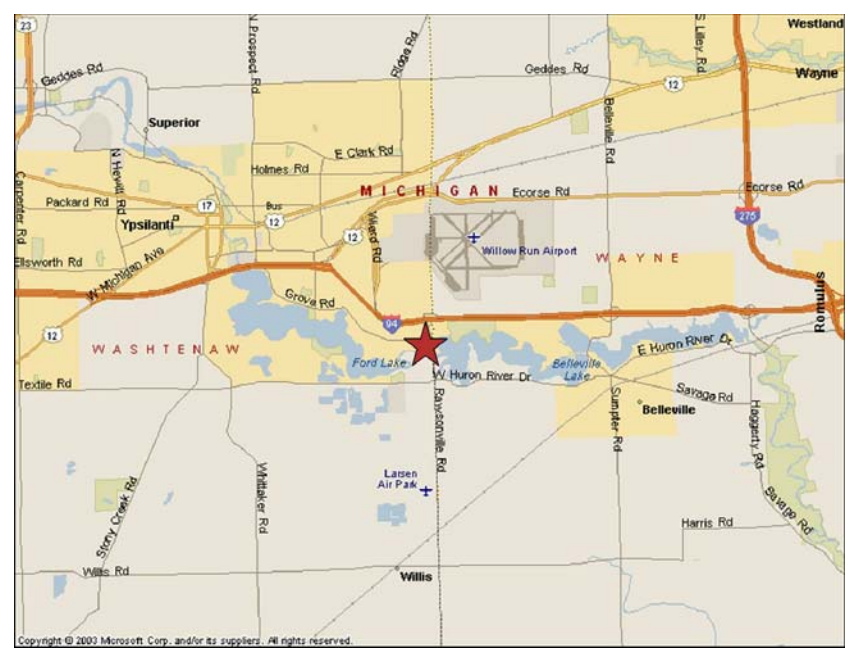

VICINITY MAP
NO SCALE

NOTE:
LAYOUT, DIMENSIONS, LOCATIONS AND SIZES ETC. ALL SUBJECT TO VERIFICATION AND FINAL REVIEW OF ARCHITECT AND OWNER. PLAN IS FOR INFORMATIONAL PURPOSES ONLY.
PROSPECTIVE TENANT NAMES ARE REPRESENTATIVE OF CURRENT INTEREST AND ACTIVITY AND DO NOT CONSTITUTE A LISTING OF EXECUTED LEASES. OWNER ASSUMES NO LIABILITY FOR THE INFORMATION SHOWN AND OFFERS NO ASSURANCE THAT THIS PLAN CAN BE MET OR IS OTHERWISE ATTAINABLE.

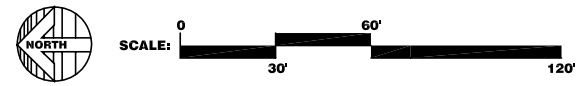

1834L28_3-21-05

PROJECT
LAKWOOD S.C.
VAN BUREN TWP. MICHIGAN

DRAWING TITLE
LEASE PLAN

DATE 10/14/08	DRAWN BY KTH	DRAWING # L-1
APPROVED BY		



Lakewood Center
Van Buren Twp., MI



I-94 South Service Dr



Lakewood Center



Raysonville Rd (Average Daily Traffic - 27,106)

Morris Ave

Margery St

Nancy St

Grove Rd (Average Daily Traffic - 10,479)

© 2006 Europa Technologies
© 2006 Navteq

© 2005 Google



Date: 05/05/10

Current Geography Selection: (3 Selected) 1,3,5 mile radii: RAWSONVILLE RD & I 94, BELLEVILLE, MI 48111

Your title for this geography: Lakewood SC

Lat: 42.218280 Long: -83.545780

County: Washtenaw County Pop: 361,395

Zip: 48111 Pop: 44,361

Demographic Snapshot Comparison Report

	1 Miles:	3 Miles:	5 Miles:
Population: 2009			
Total Population	1,663	40,656	116,188
Male Population	49.7%	49.9%	49.5%
Female Population	50.3%	50.1%	50.5%
Median Age	32.7	34.4	32.3
Population Density (per sq. mi.)	529.2	1,437.9	1,479.4
Employees	1,106	11,663	31,460
Establishments	80	1,035	2,659
Income: 2009			
Median HH Income	\$54,717	\$59,660	\$57,711
Per Capita Income	\$17,817	\$23,503	\$23,255
Average HH Income	\$52,825	\$62,299	\$61,977
Households: 2009			
Total Households	585	15,415	42,376
Average Household Size	2.84	2.64	2.66
Household Growth 1990 - 2000	2.6%	12.6%	18.1%
Housing: 2009			
Owner Occupied Housing Units	55.4%	60.1%	59.1%
Renter Occupied Housing Units	30.3%	25.7%	25.4%
Vacant Housing Units	14.3%	14.2%	15.5%
Race: 2009			
White	60.4%	72.1%	70.3%
Black	31.9%	20.6%	21.7%
American Indian, Eskimo, Aleut	0.1%	0.3%	0.3%
Asian	2.4%	3.0%	3.6%
Hawaiian or Pacific Islander	0.1%	0.0%	0.1%
Other	2.1%	1.1%	1.0%

Multirace	3.1%	3.0%	3.1%
Ethnicity: 2009			
Hispanic	3.5%	3.3%	3.1%
Non-Hispanic	96.5%	96.7%	96.9%

Current year data is for the year 2009, 5 year projected data is for the year 2014. [More About Our Data.](#)
Demographic data © 2009 by Experian/Applied Geographic Solutions.

© 2010. DemographicsNow is brought to you by Alteryx, LLC.

Alteryx, DemographicsNow.com and the Alteryx and DemographicsNow.com logos are trademarks of Alteryx, LLC.

All rights reserved.

[Privacy Statement](#) | [License Agreement](#)