

THE LANDINGS

SARASOTA, FLORIDA

LEASE DATA		
4960	Available	2,100 SF
4968	The Clock Gallery	1,800 SF
4974	The Collector's Wall	1,700 SF
4982	The Corkscrew	900 SF
4986	Landing's Travel	1,080 SF
4990	Sacino's Formalwear	1,483 SF

LEASE DATA		
4800	Available	1,050 SF
4804	Fernan's	1,750 SF
4808	Landings Cleaners	1,400 SF
4820	Drapers & Damon's	4,370 SF
4824	Voipe Salon & Spa	1,801 SF
4828	Sally Beauty Supplies	1,480 SF
4832	Peaches	2,733 SF

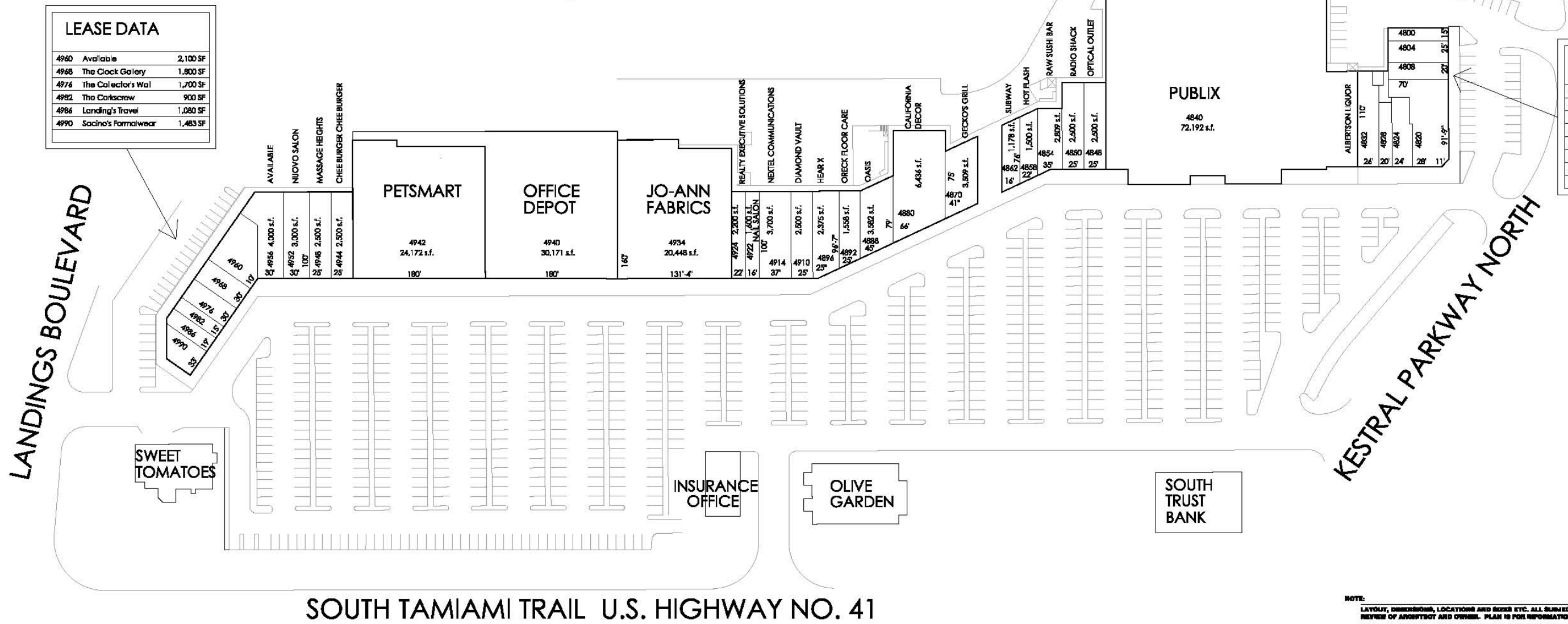

SOUTH TAMIAMI TRAIL U.S. HIGHWAY NO. 41

NOTE:
LAYOUT, DIMENSIONS, LOCATIONS AND FEES ETC. ALL SUBJECT TO VERIFICATION AND FINAL REVIEW OF ARCHITECT AND OWNER. PLAN IS FOR INFORMATIONAL PURPOSES ONLY.
PROSPECTIVE TENANT NAMES ARE REPRESENTATIVE OF CURRENT TENANCY AND ACTIVITY AND DO NOT CONSTITUTE A LISTING OF EXISTING LEASES. OWNER ASSUMES NO LIABILITY FOR THE INFORMATION SHOWN AND OFFERS NO ASSURANCE THAT THIS PLAN CAN BE MET OR IS OTHERWISE ATTAINABLE.



VICINITY MAP (NTS)

BUILDING DATA	
AREA	
TOTAL BUILDING AREA:	226,488 SF
PARKING	
PARKING PROVIDED	972 SPACES
HC PARKING PROVIDED	38 SPACES
TOTAL PROVIDED	1010 SPACES

PROJECT **THE LANDINGS**
SARASOTA, FLORIDA

DRAWING TITLE **LEASE PLAN**

DATE 4/8/08 DRAWN BY APPROVED BY DRAWING # **SL-1**



The Landings
Sarasota, FL



Albertsons
Crazy about food.

The Landings

JOANN
Office DEPOT
PETSMART

Proctor Rd

La Salle St

Lee Ln

Shawnee St

Outer Dr

Phillippi St

41

S. Tamiami Trail (Average Daily Traffic - 58,000)

Susan Ave

©2007 Europa Technologies
©2007 Navteq
©2005 Google



Date: 05/05/10

Current Geography Selection: (3 Selected) 1,3,5 mile radii: S TAMIAMI TRL & PROCTOR RD, SARASOTA, FL 34231

Your title for this geography: The Landings

Lat: 27.284620 **Long:** -82.530750

City: South Sarasota **Pop:** 5,159

County: Sarasota County **Pop:** 376,498

Zip: 34231 **Pop:** 30,625

Demographic Snapshot Comparison Report

	1 Miles:	3 Miles:	5 Miles:
Population: 2009			
Total Population	7,603	57,871	135,010
Male Population	49.3%	47.6%	47.9%
Female Population	50.7%	52.4%	52.2%
Median Age	47.0	49.4	47.6
Population Density (per sq. mi.)	2,420.1	2,046.8	1,719.0
Employees	4,651	40,466	102,215
Establishments	499	4,059	9,564
Income: 2009			
Median HH Income	\$59,582	\$54,734	\$53,040
Per Capita Income	\$39,675	\$36,439	\$32,229
Average HH Income	\$89,866	\$79,667	\$72,477
Households: 2009			
Total Households	3,343	26,418	59,146
Average Household Size	2.27	2.18	2.25
Household Growth 1990 - 2000	7.9%	1.9%	9.6%
Housing: 2009			
Owner Occupied Housing Units	56.5%	48.9%	48.0%
Renter Occupied Housing Units	20.9%	19.2%	22.5%
Vacant Housing Units	22.7%	32.0%	29.5%
Race: 2009			
White	94.9%	95.1%	90.9%
Black	1.2%	1.3%	4.5%
American Indian, Eskimo, Aleut	0.2%	0.2%	0.2%
Asian	1.5%	1.4%	1.4%
Hawaiian or Pacific Islander	0.0%	0.0%	0.0%

Other	1.2%	1.0%	1.8%
Multirace	1.1%	1.0%	1.3%
Ethnicity: 2009			
Hispanic	7.7%	7.2%	11.6%
Non-Hispanic	92.3%	92.8%	88.4%

Current year data is for the year **2009**, 5 year projected data is for the year **2014**. More About Our Data.
Demographic data © 2009 by Experian/Applied Geographic Solutions.

© **2010. DemographicsNow is brought to you by Alteryx, LLC.**

Alteryx, DemographicsNow.com and the Alteryx and DemographicsNow.com logos are trademarks of Alteryx, LLC.
All rights reserved.

[Privacy Statement](#) | [License Agreement](#)