

# THE LANDINGS

## SARASOTA, FLORIDA

LEASE DATA		
4960	Available	2,100 SF
4968	Available	1,800 SF
4976	The Collector's Wall	1,700 SF
4982	The Corkscrew	900 SF
4986	Landing's Travel	1,080 SF
4990	Available	1,483 SF

LEASE DATA		
4800	Available	1,050 SF
4804	Ferrari's	1,750 SF
4808	Landings Cleaners	1,400 SF
4820	Drapers & Damon's	4,370 SF
4824	Volpe Salon & Spa	1,801 SF
4828	Sally Beauty Supplies	1,480 SF
4832	Peaches	2,733 SF

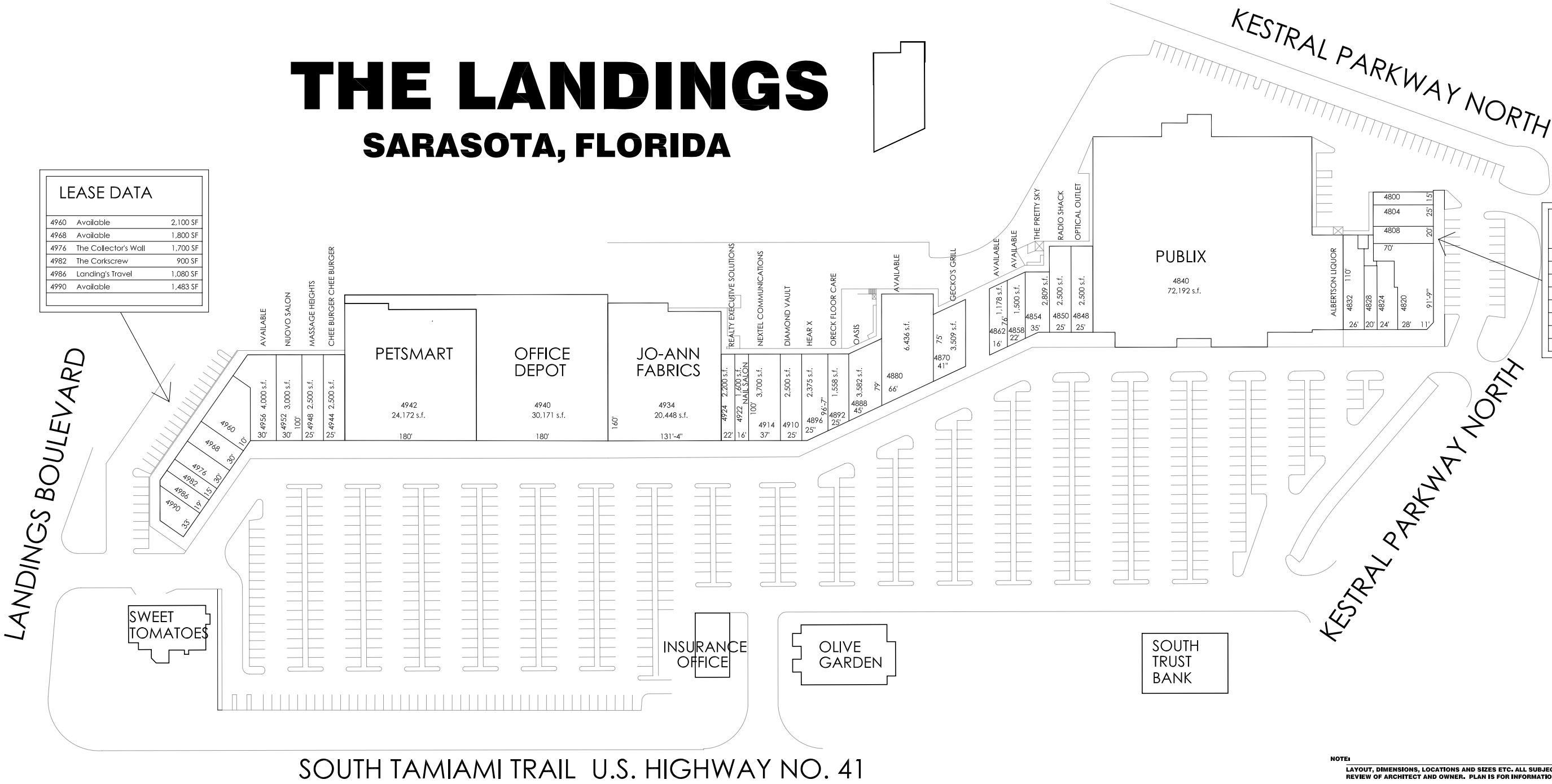

SOUTH TAMiami TRAIL U.S. HIGHWAY NO. 41

**NOTE:**  
LAYOUT, DIMENSIONS, LOCATIONS AND SIZES ETC. ALL SUBJECT TO VERIFICATION AND FINAL REVIEW OF ARCHITECT AND OWNER. PLAN IS FOR INFORMATIONAL PURPOSES ONLY.  
PROSPECTIVE TENANT NAMES ARE REPRESENTATIVE OF CURRENT INTEREST AND ACTIVITY AND DO NOT CONSTITUTE A LISTING OF EXECUTED LEASES. OWNER ASSUMES NO LIABILITY FOR THE INFORMATION SHOWN AND OFFERS NO ASSURANCE THAT THIS PLAN CAN BE MET OR IS OTHERWISE ATTAINABLE.

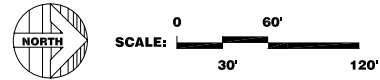

38915L1\_B-24-05



VICINITY MAP (NTS)

BUILDING DATA	
AREA	
TOTAL BUILDING AREA:	226,488 SF
PARKING	
PARKING PROVIDED	972 SPACES
HC PARKING PROVIDED	38 SPACES
TOTAL PROVIDED	1010 SPACES

<b>PROJECT</b>		
<b>THE LANDINGS</b>		
SARASOTA, FLORIDA		
<b>DRAWING TITLE</b>		
<b>LEASE PLAN</b>		
<b>REVISIONS</b>	<b>DATE</b>	<b>DRAWING #</b>
	1/11/10	SL-1
<b>DRAWN BY</b>	<b>APPROVED BY</b>	

