

**TENANT ROSTER**

- R-103 Sublease to Rite Aid - 1,088 SF
- R-105 Rite Aid - 13,566 SF
- R-108 Available - 6,306 SF**
- R-109 Bath & Body - 2,629 SF
- R-110 Dress Barn - 7,651 SF
- R-112 GNC - 1,346 SF
- R-113 Gibbs World Wide Win - 1,085 SF
- R-114 Claire's Boutique - 888 SF
- R-115 Bo Ric's - 1,107 SF
- R-116 Buddy's Pizza - 1,669 SF
- R-117A Curves - 3,679 SF
- R-117B Available - 2,501 SF**
- R-118 SVS Vision - 2,776 SF
- R-119 Available - 2,188 SF**
- R-120 Available - 4,175 SF**
- R-125 Barnes & Noble - 12,482 SF

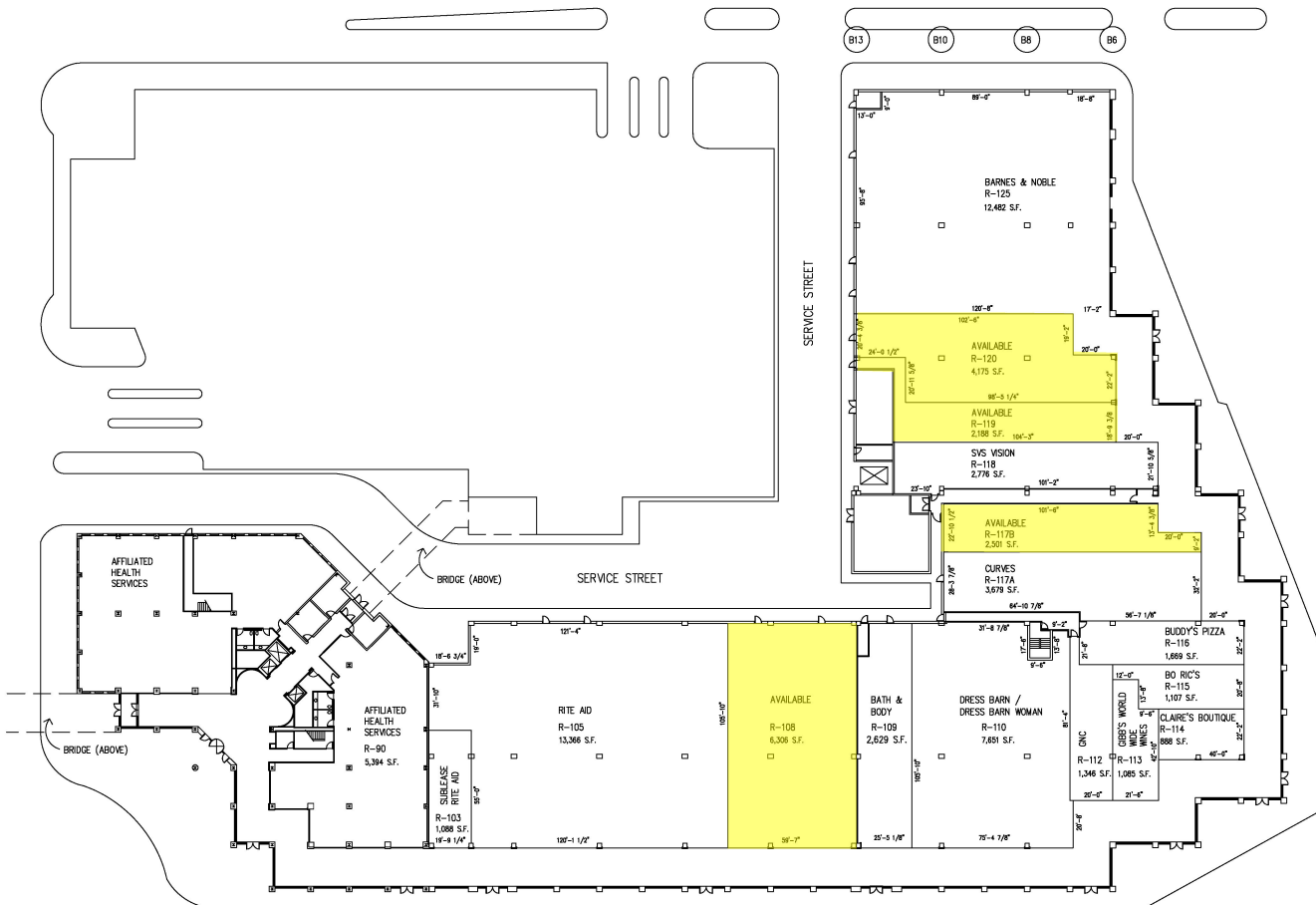

PROJECT	<b>POINTE PLAZA GROSSE POINTE, MICHIGAN</b>		
REVISIONS	DRAWING TITLE <b>LEASE PLAN</b>		
DATE 8/26/11	DRAWN BY	DRAWING # <b>SL-1</b>	
	APPROVED BY		

**Schostak**  
BROTHERS & COMPANY  
17800 LAUREL PARK DRIVE NORTH #200C (248)262-1000 LIVONIA, MICHIGAN 48152

