

VICINITY MAP

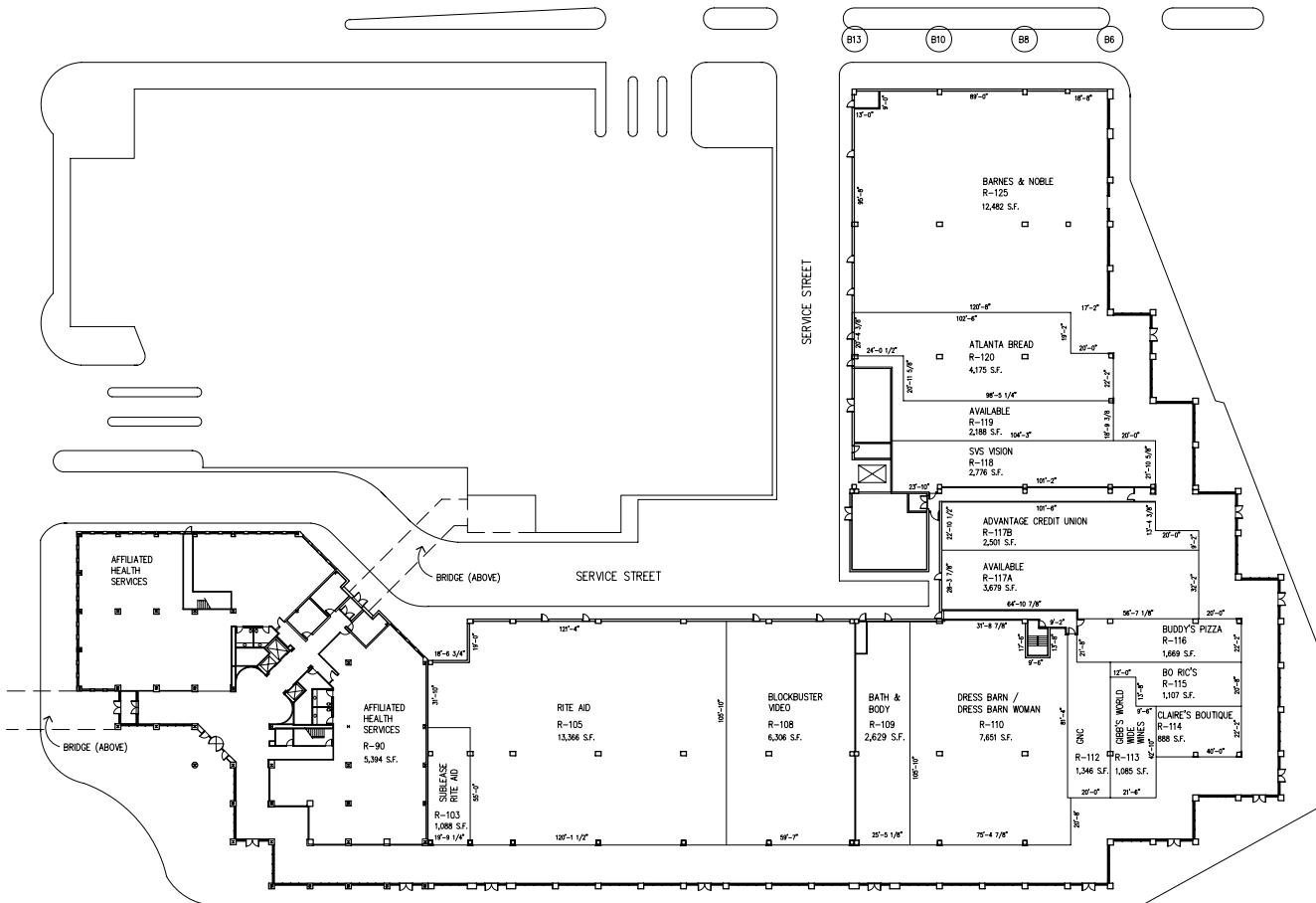

SCALE: NONE

PROJECT	POINTE PLAZA GROSSE POINTE, MICHIGAN		
REVISIONS	DRAWING TITLE		
	LEASE PLAN		
	DATE	DRAWN BY	DRAWING #
	1/5/10	APPROVED BY	SL-1

Schostak
BROTHERS & COMPANY
17800 LAUREL PARK DRIVE NORTH #200C (248)262-1000 LIVONIA, MICHIGAN 48152

