

WOODWARD AVE. (66')

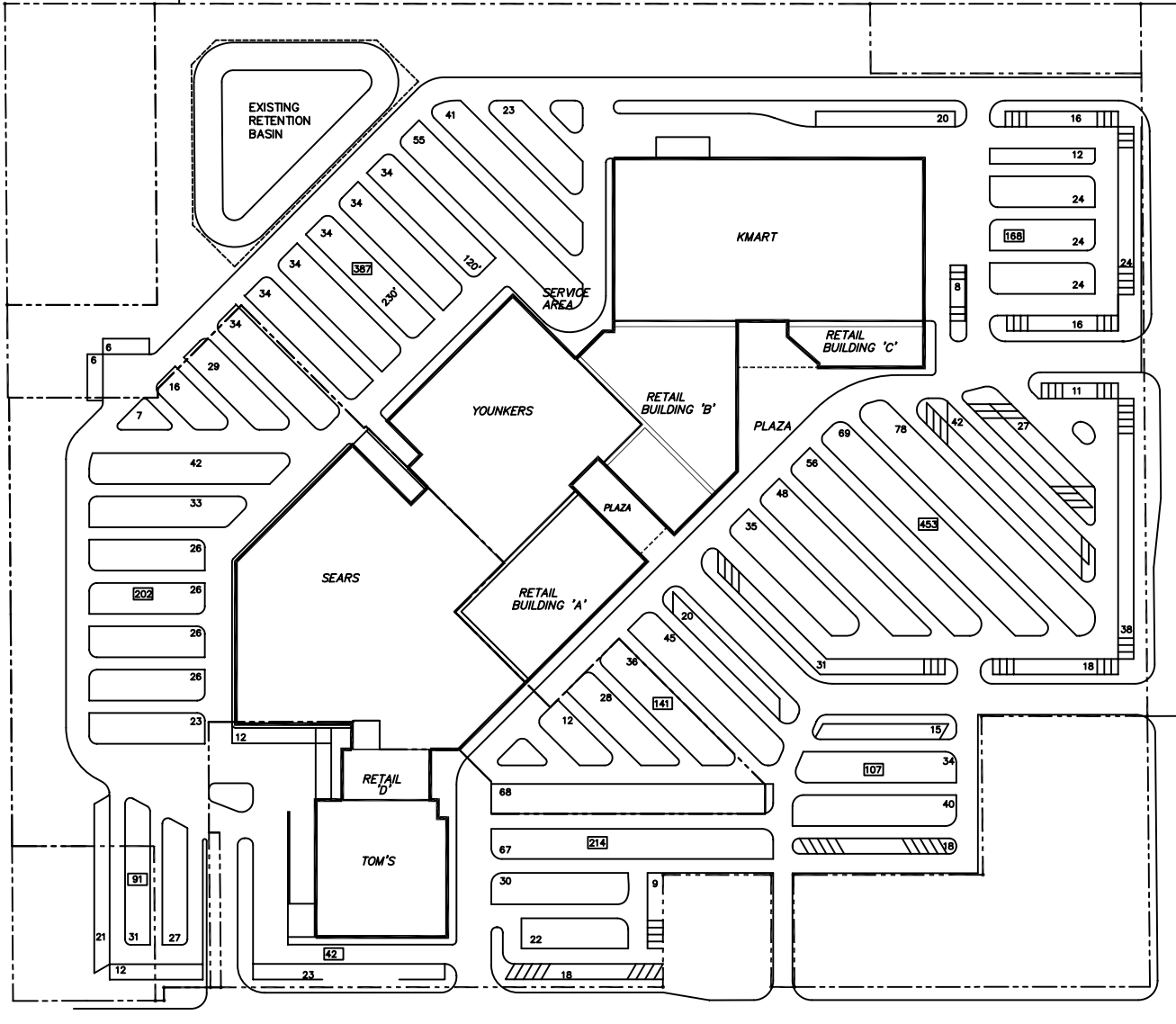

Q GARFIELD ROAD

Q SOUTH AIRPORT ROAD

SITE PLAN

SCALE: 1" = 100'-0"



CHERRYLAND SHOPPING CENTER
TRAVERSE CITY, MICHIGAN

TABULATION:

LAND AREA:	
1. SHOPPING CENTER	28.21 ACRES
2. SEARS	8.48 ACRES
TOTAL 36.69 ACRES	

BUILDING AREA (G.L.A.):

1. KMART	84,180 S.F.
2. SEARS	96,695 S.F.
3. YOUNKERS	57,594 S.F.
4. RETAIL BUILDING 'A'	26,283 S.F.
5. RETAIL BUILDING 'B'	34,272 S.F.
6. RETAIL BUILDING 'C'	9,749 S.F.
7. RETAIL 'D'	7,800 S.F.
8. TOM'S	30,975 S.F.
TOTAL 347,548 S.F.	

PARKING CAPACITY PROVIDED: 1,743 CARS (ESTIMATE)

PARKING CAPACITY REQUIRED: 1,564 CARS (4.5 CARS / 1,000 G.L.A.)

NOTE: LAYOUT, DIMENSIONS, LOCATIONS AND SIZES, ETC. ALL SUBJECT TO VERIFICATION AND FINAL REVIEW OF ARCHITECT AND OWNER. PLAN IS FOR INFORMATIONAL PURPOSES ONLY. PROSPECTIVE TENANT NAMES ARE REPRESENTATIVE OF CURRENT INTEREST AND ACTIVITY AND DO NOT CONSTITUTE A LISTING OF EXECUTED LEASES. OWNER ASSUMES NO LIABILITY FOR THE INFORMATION SHOWN AND OFFERS NO ASSURANCE THAT THIS PLAN CAN BE MET OR IS OTHERWISE ATTAINABLE.



SCALE: 1" = 100'-0"
0 100' 200' 300'

PROJECT
CHERRYLAND CENTER
TRAVERSE CITY, MICHIGAN

REVISIONS

DRAWING TITLE
SITE LEASE PLAN

DATE 23 AUG 07	DRAWN BY APPROVED BY	DRAWING # L-SC
-------------------	-------------------------	-------------------



17672 Laurel Park Drive N. Livonia, MI 48152
(248) 262-1000